

Slip-On Welding FF

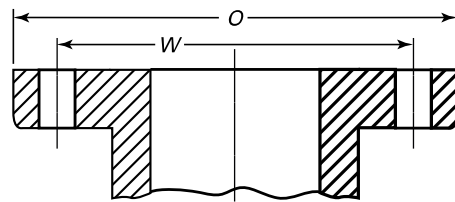

* Referential photo



Speed Logística y Servicios S.A.C. Importador y distribuidor autorizado de bridas FR para Perú y para su exportación.

Dimensions are in mm

Nominal Pipe Size, NPS		Outside Diameter of Flange (O)	Minimum Thickness of Flange, (t _f)	Diameter of Hub (X)	Length Through Hub (Y)	Bore Minimum (B)	Diameter of Bolt Circle (W)	Diameter of Bolt Holes (inch)	Number of Bolts	Diameter of Bolts (inch)	Weight Approx. (kg)
inch	mm										
1/2"	12	90	9.6	30	14	22.2	60.3	5/8	4	1/2	0.47
3/4"	18	100	11.2	38	14	27.7	69.9	5/8	4	1/2	0.59
1"	25	110	12.7	49	16	34.5	79.4	5/8	4	1/2	0.86
1 1/4"	31	115	14.3	59	19	43.2	88.9	5/8	4	1/2	1.08
1 1/2"	38	125	15.9	65	21	49.5	98.4	5/8	4	1/2	1.41
2"	50	150	17.5	78	24	61.9	120.7	3/4	4	5/8	2.26
2 1/2"	63	180	20.7	90	27	74.6	139.7	3/4	4	5/8	3.43
3"	75	190	22.3	108	29	90.7	152.4	3/4	4	5/8	3.87
3 1/2"	88	215	22.3	122	30	103.4	177.8	3/4	8	5/8	4.45
4"	100	230	22.3	135	32	116.1	190.5	3/4	8	5/8	5.75
5"	125	255	22.3	164	35	143.8	215.9	7/8	8	3/4	6.22
6"	150	280	23.9	192	38	170.7	241.3	7/8	8	3/4	7.38
8"	200	345	27.0	246	43	221.5	298.5	7/8	8	3/4	12.36
10"	250	405	28.6	305	48	276.2	362.0	1	12	7/8	17.10
12"	300	485	30.2	365	54	327.0	431.8	1	12	7/8	27.68
14"	350	535	33.4	400	56	359.2	476.3	1 1/8	12	1	35.20
16"	400	595	35.0	457	62	410.5	539.8	1 1/8	16	1	42.18
18"	450	635	38.1	505	67	461.8	577.9	1 1/4	16	1 1/8	49.71
20"	500	700	41.3	559	71	513.1	635.0	1 1/4	20	1 1/8	65.50
22"	550	750	44.5	610	78	564.4	692.2	1 3/8	20	1 1/4	78.48
24"	600	815	46.1	663	81	616.0	749.3	1 3/8	20	1 1/4	90.50

Note (1) This dimension is for large end of hub, which may be straight or tapered. Taper shall not exceed 7 deg on threaded, slip-on, socket-welding, and lapped flanges. This dimension is defined as the diameter at the intersection between the hub taper and back face of the flange.

*** Note : Dimensions, design and materials are subject to change without notice. Reference weights**