

Slip-On Welding

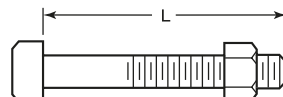

Machine Bolt With Nuts

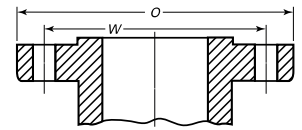

Stud Bolts With Nuts

Point height
(Note 1)

Note 1: The length of the stud bolt does not include the height of the points

* Referential photo

Speed Logística y Servicios S.A.C. Importador y distribuidor autorizado de bridas FR para Perú y para su exportación.

Dimensions are in mm

Nominal Pipe Size, NPS	Outside Diameter of Flange (O)	Minimum Thickness of Flange, (t _f)	Diameter of Hub (X)	Length Through Hub (Y)	Bore Minimum (B)	Diameter of Bolt Circle (W)	Diameter of Bolt Holes (inch)	Number of Bolts	Diameter of Bolts (inch)	Length of Bolts (L)			Weight Approx. (kg)	
										Stud Bolts		Machine Bolts		
										2mm Raised Face	Ring Joint	2mm Raised Face		
1/2"	12	95	12.7	38	21	22.2	66.7	5/8	4	1/2	65	75	55	55
3/4"	18	115	14.3	48	24	27.7	82.6	3/4	4	5/8	75	90	65	65
1"	25	125	15.9	54	25	34.5	88.9	3/4	4	5/8	75	90	65	65
1 1/4"	31	135	17.5	64	25	43.2	98.4	3/4	4	5/8	85	95	70	70
1 1/2"	38	155	19.1	70	29	49.5	114.3	7/8	4	3/4	90	100	75	75
2"	50	165	20.7	84	32	61.9	127.0	3/4	8	5/8	90	100	75	75
2 1/2"	63	190	23.9	100	37	74.6	149.2	7/8	8	3/4	100	115	85	85
3"	75	210	27.0	117	41	90.7	168.3	7/8	8	3/4	110	120	90	90
3 1/2"	88	230	28.6	133	43	103.4	184.2	7/8	8	3/4	110	125	95	-
4"	100	255	30.2	146	46	116.1	200.0	7/8	8	3/4	115	125	95	95
5"	125	280	33.4	178	49	143.8	235.0	7/8	8	3/4	120	135	110	110
6"	150	320	35.0	206	51	170.7	269.9	7/8	12	3/4	120	140	110	110
8"	200	380	39.7	260	60	221.5	330.2	1	12	7/8	140	150	120	120
10"	250	445	46.1	321	65	276.2	387.4	1 1/8	16	1	160	170	140	140
12"	300	520	49.3	375	71	327.0	450.8	1 1/4	16	1 1/8	170	185	145	145
14"	350	585	52.4	425	75	359.2	514.4	1 1/4	20	1 1/8	180	190	160	160
16"	400	650	55.6	483	81	410.5	571.5	1 3/8	20	1 1/4	190	205	165	165
18"	450	710	58.8	533	87	461.8	628.6	1 3/8	24	1 1/4	195	210	170	170
20"	500	775	62.0	587	94	513.1	685.8	1 3/8	24	1 1/4	205	220	185	185
22"	550	840	65.1	640	100	564.4	743.0	1 5/8	24	1 1/2	230	255	205	-
24"	600	915	68.3	702	105	616.0	812.8	1 5/8	24	1 1/2	230	255	205	205

Note (1) This dimension is for large end of hub, which may be straight or tapered. Taper shall not exceed 7 deg on threaded, slip-on, socket-welding, and lapped flanges. This dimension is defined as the diameter at the intersection between the hub taper and back face of the flange.

* Note : Dimensions, design and materials are subject to change without notice. Reference weights

MAC - MMXXIV

