

Welding Neck

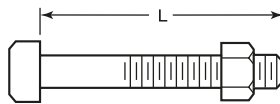

Machine Bolt With Nuts

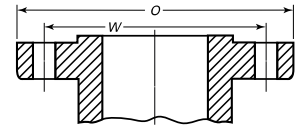
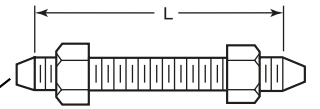

Stud Bolts With Nuts

Point height  
(Note 1)

Note 1: The length of the stud bolt does not include the height of the points

\* Referential photo



Speed Logística y Servicios S.A.C. Importador y distribuidor autorizado de bridas FR para Perú y para su exportación.

Dimensions are in mm

Nominal Pipe Size, NPS		Outside Diameter of Flange (O)	Minimum Thickness of Flange, (t <sub>f</sub> )	Diameter of Hub (X)	Hub Diameter Beginning of Chamfer Welding Neck (A <sub>h</sub> )	Length Through Hub (Y)	Bore (B)	Diameter of Bolt Circle (W)	Diameter of Bolt Holes (inch)	Number of Bolts	Diameter of Bolts (inch)	Length of Bolts (L)			Weight Approx. (kg)
												Stud Bolts		Machine Bolts	
												2mm Raised Face	Ring Joint	2mm Raised Face	
inch	mm														
1/2"	12	95	12.7	38	21.3	51	15.8	66.7	5/8	4	1/2	65	75	55	0.78
3/4"	18	115	14.3	48	26.7	56	20.9	82.6	3/4	4	5/8	75	90	65	1.34
1"	25	125	15.9	54	33.4	60	26.6	88.9	3/4	4	5/8	75	90	65	1.64
1 1/4"	31	135	17.5	64	42.2	64	35.1	98.4	3/4	4	5/8	85	95	70	2.06
1 1/2"	38	155	19.1	70	48.3	67	40.9	114.3	7/8	4	3/4	90	100	75	3.06
2"	50	165	20.7	84	60.3	68	52.5	127.0	3/4	8	5/8	90	100	75	3.40
2 1/2"	63	190	23.9	100	73.0	75	62.7	149.2	7/8	8	3/4	100	115	85	5.31
3"	75	210	27.0	117	88.9	78	77.9	168.3	7/8	8	3/4	110	120	90	7.32
3 1/2"	88	230	28.6	133	101.6	79	90.1	184.2	7/8	8	3/4	110	125	95	-
4"	100	255	30.2	146	114.3	84	102.3	200.0	7/8	8	3/4	115	125	95	11.30
5"	125	280	33.4	178	141.3	97	128.2	235.0	7/8	8	3/4	120	135	110	15.12
6"	150	320	35.0	206	168.3	97	154.1	269.9	7/8	12	3/4	120	140	110	19.68
8"	200	380	39.7	260	219.1	110	202.7	330.2	1	12	7/8	140	150	120	30.48
10"	250	445	46.1	321	273.0	116	254.6	387.4	1 1/8	16	1	160	170	140	43.74
12"	300	520	49.3	375	323.8	129	304.8	450.8	1 1/4	16	1 1/8	170	185	145	64.41
14"	350	585	52.4	425	355.6	141	[Note 1]	514.4	1 1/4	20	1 1/8	180	190	160	88.30
16"	400	650	55.6	483	406.4	144	[Note 1]	571.5	1 3/8	20	1 1/4	190	205	165	112.94
18"	450	710	58.8	533	457.0	157	[Note 1]	628.6	1 3/8	24	1 1/4	195	210	170	138.34
20"	500	775	62.0	587	508.0	160	[Note 1]	685.8	1 3/8	24	1 1/4	205	220	185	167.37
22"	550	840	65.1	640	558.8	164	[Note 1]	743.0	1 5/8	24	1 1/2	230	255	205	-
24"	600	915	68.3	702	610.0	167	[Note 1]	812.8	1 5/8	24	1 1/2	230	255	205	235.41

Note (1) To be specified by the purchaser.

\* Note : Dimensions, design and materials are subject to change without notice. Reference weights