

Slip-On Welding

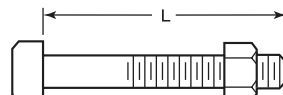

Machine Bolt With Nuts

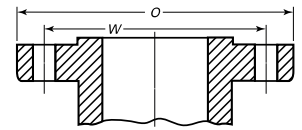

Stud Bolts With Nuts

Point height (Note 1)

Note 1: The length of the stud bolt does not include the height of the points

\* Referential photo



Speed Logística y Servicios S.A.C. Importador y distribuidor autorizado de bridas FR para Perú y para su exportación.

Dimensions are in mm

Nominal Pipe Size, NPS		Outside Diameter of Flange (O)	Minimum Thickness of Flange, (t <sub>f</sub> )	Diameter of Hub (X)	Length Through Hub (Y)	Bore Minimum (B)	Diameter of Bolt Circle (W)	Diameter of Bolt Holes (inch)	Number of Bolts	Diameter of Bolts (inch)	Length of Bolts (L)			Weight Approx. (kg)
inch	mm										7mm Raised Face	Male and Female / Tongue and Groove	Ring Joint	
1/2"	12	95	14.3	38	22	22.2	66.7	5/8	4	1/2	75	70	75	0.91
3/4"	18	115	15.9	48	25	27.7	82.6	3/4	4	5/8	90	85	90	1.40
1"	25	125	17.5	54	27	34.5	88.9	3/4	4	5/8	90	85	90	1.70
1 1/4"	31	135	20.7	64	29	43.2	98.4	3/4	4	5/8	95	90	95	2.27
1 1/2"	38	155	22.3	70	32	49.5	114.3	7/8	4	3/4	110	100	110	3.10
2"	50	165	25.4	84	37	61.9	127.0	3/4	8	5/8	110	100	110	3.63
2 1/2"	63	190	28.6	100	41	74.6	149.2	7/8	8	3/4	120	115	120	5.44
3"	75	210	31.8	117	46	90.7	168.3	7/8	8	3/4	125	120	125	7.26
3 1/2"	88	230	35.0	133	49	103.4	184.2	1	8	7/8	140	135	140	-
4"	100	275	38.1	152	54	116.1	215.9	1	8	7/8	145	140	145	14.97
5"	125	330	44.5	189	60	143.8	266.7	1 1/8	8	1	165	160	165	28.50
6"	150	355	47.7	222	67	170.7	292.1	1 1/8	12	1	170	165	170	36.32
8"	200	420	55.6	273	76	221.5	349.2	1 1/4	12	1 1/8	190	185	195	44.00
10"	250	510	63.5	343	86	276.2	431.8	1 3/8	16	1 1/4	215	210	210	76.20
12"	300	560	66.7	400	92	327.0	489.0	1 3/8	20	1 1/4	220	215	220	97.52
14"	350	605	69.9	432	94	359.2	527.0	1 1/2	20	1 3/8	235	230	235	102.00
16"	400	685	76.2	495	106	410.5	603.2	1 5/8	20	1 1/2	255	250	255	149.82
18"	450	745	82.6	546	117	461.8	654.0	1 3/4	20	1 5/8	275	265	275	180.10
20"	500	815	88.9	610	127	513.1	723.9	1 3/4	24	1 5/8	285	280	290	231.54
22"	550	870	95.2	663	133	564.4	777.7	1 7/8	24	1 3/4	305	---	310	-
24"	600	940	101.6	718	140	616.0	838.2	2	24	1 7/8	330	325	335	330.00

Note (1) This dimension is for large end of hub, which may be straight or tapered. Taper shall not exceed 7 deg on threaded, slip-on, socket-welding, and lapped flanges. This dimension is defined as the diameter at the intersection between the hub taper and back face of the flange.

\* Note : Dimensions, design and materials are subject to change without notice. Reference weights

MAC - MMXXIV

