

Slip-On Welding

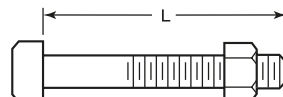

Machine Bolt With Nuts

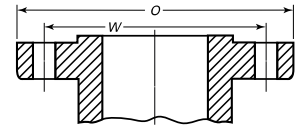
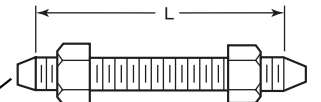

Stud Bolts With Nuts

Point height (Note 1)

Note 1: The length of the stud bolt does not include the height of the points

* Referential photo



Speed Logística y Servicios S.A.C. Importador y distribuidor autorizado de bridas FR para Perú y para su exportación.

Dimensions are in mm

Nominal Pipe Size, NPS		Outside Diameter of Flange (O)	Minimum Thickness of Flange, (t _f)	Diameter of Hub (X)	Length Through Hub (Y)	Bore Minimum (B)	Diameter of Bolt Circle (W)	Diameter of Bolt Holes (inch)	Number of Bolts	Diameter of Bolts (inch)	Length of Bolts (L)			Weight Approx. (kg)
inch	mm										7mm Raised Face	Male and Female / Tongue and Groove	Ring Joint	
1/2"	12	120	22.3	38	32	22.2	82.6	7/8	4	3/4	110	100	110	1.75
3/4"	18	130	25.4	44	35	27.7	88.9	7/8	4	3/4	115	110	115	2.34
1"	25	150	28.6	52	41	34.5	101.6	1	4	7/8	125	120	125	3.44
1 1/4"	31	160	28.6	64	41	43.2	111.1	1	4	7/8	125	120	125	3.92
1 1/2"	38	180	31.8	70	44	49.5	123.8	1 1/8	4	1	140	135	140	5.38
2"	50	215	38.1	105	57	61.9	165.1	1	8	7/8	145	140	145	9.87
2 1/2"	63	245	41.3	124	64	74.6	190.5	1 1/8	8	1	160	150	160	13.37
3"	75	240	38.1	127	54	90.7	190.5	1	8	7/8	145	140	145	11.63
4"	100	290	44.5	159	70	116.1	235.0	1 1/4	8	1 1/8	170	165	170	19.79
5"	125	350	50.8	190	79	143.8	279.4	1 3/8	8	1 1/4	190	185	190	32.00
6"	150	380	55.6	235	86	170.7	317.5	1 1/4	12	1 1/8	190	185	195	41.17
8"	200	470	63.5	298	102	221.5	393.7	1 1/2	12	1 3/8	220	215	220	70.82
10"	250	545	69.9	368	108	276.2	469.9	1 1/2	16	1 3/8	235	230	235	100.71
12"	300	610	79.4	419	117	327.0	533.4	1 1/2	20	1 3/8	255	250	255	133.01
14"	350	640	85.8	451	130	359.2	558.8	1 5/8	20	1 1/2	275	265	280	153.41
16"	400	705	88.9	508	133	410.5	616.0	1 3/4	20	1 5/8	285	280	290	185.05
18"	450	785	101.6	565	152	461.8	685.8	2	20	1 7/8	325	320	335	258.72
20"	500	855	108.0	622	159	513.1	749.3	2 1/8	20	2	350	345	360	317.40
24"	600	1040	139.7	749	203	616.0	901.7	2 5/8	20	2 1/2	440	430	455	605.55

Note (1) This dimension is for large end of hub, which may be straight or tapered. Taper shall not exceed 7 deg on threaded, slip-on, socket-welding, and lapped flanges. This dimension is defined as the diameter at the intersection between the hub taper and back face of the flange.

* Note : Dimensions, design and materials are subject to change without notice. Reference weights

MAC - MMXXIV

