

90

90° Elbow

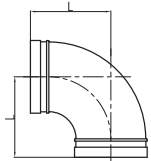

Nominal Size mm/in	Pipe O.D mm/in	Working Pressure PSI/MPa	Dimensions L mm/in	Certificate
25 1	33.7 1.315	500 3.45	57 2.24	UL FM VdS LPCB
32 1¼	42.4 1.680	500 3.45	70 2.75	UL FM VdS LPCB
40 1½	48.3 1.900	500 3.45	70 2.75	UL FM VdS LPCB
50 2	60.3 2.375	500 3.45	82.5 3.25	UL FM VdS LPCB
65 2½	73.0 2.875	500 3.45	95 3.74	UL FM
65 2½	76.1 3.000	500 3.45	95 3.74	UL FM VdS LPCB
80 3	88.9 3.500	500 3.45	108 4.25	UL FM VdS LPCB
100 4	114.3 4.500	500 3.45	127 5.00	UL FM VdS LPCB
125 5	133.0 5.250	500 3.45	122 4.80	UL FM
125 5	139.7 5.500	500 3.45	140 5.50	UL FM VdS LPCB
125 5	141.3 5.583	500 3.45	140 5.50	UL FM
150 6	165.1 6.500	500 3.45	165 6.50	UL FM LPCB
150 6	168.3 6.625	500 3.45	165 6.50	UL FM VdS LPCB
200 8	219.1 8.625	500 3.45	197 7.75	UL FM VdS LPCB
250 10	267.4 10.528	300 2.07	229 9.00	UL FM
250 10	273.0 10.750	300 2.07	229 9.00	UL FM VdS
300 12	318.5 12.539	300 2.07	254 10.00	UL FM
300 12	323.9 12.750	300 2.07	254 10.00	UL FM VdS
350 14	355.6 14.000	300 2.07	280 11.02	—
350 14	377.0 14.84	300 2.07	279 10.98	—
400 16	406.4 16.000	300 2.07	305 12.00	—
400 16	426.0 16.77	300 2.07	305 12.00	—
450 18	457.2 18.000	300 2.07	394 15.50	—
450 18	480.0 18.90	300 2.07	335 13.19	—
500 20	508.0 20.000	300 2.07	438 17.25	—
600 24	609.6 24.000	300 2.07	508 20.00	—