

130R

Reducing Tee

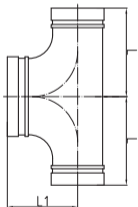

Nominal Size mm/in	Pipe O.D mm/in	Working Pressure PSI/MPa	Dimensions L mm/in	Dimensions L 1 mm/in	Certificate
65×65×80 2½×2½×3	76.1×76.1×88.9 3.000×3.000×3.500	500 3.45	108 4.25	95 3.74	—
65×65×100 2½×2½×4	76.1×76.1×114.3 3.000×3.000×4.500	500 3.45	127 5.00	102 4.02	—
80×80×100 3×3×4	88.9×88.9×114 3.500×3.500×4.500	500 3.45	127 5.00	102 4.02	—

130R

Reducing Tee

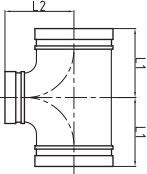

Nominal Size mm/in	Pipe O.D mm/in	Working Pressure PSI/MPa	Dimensions L 1 mm/in	Dimensions L 2 mm/in	Certificate
50×25 2×1	60.3×33.7 2.375×1.315	500 3.45	70 2.75	70 2.75	UL FM VdS LPCB
50×40 2×1½	60.3×48.3 2.375×1.900	500 3.45	70 2.75	70 2.75	UL FM VdS LPCB
65×40 2½×1½	73.0×48.3 2.875×1.900	500 3.45	76 3.00	76 3.00	UL FM
65×50 2½×2	73.0×60.3 2.875×2.375	500 3.45	69 2.72	76 3.00	UL FM
65×32 2½×1¼	76.1×42.4 3.000×1.660	500 3.45	76 3.00	76 3.00	UL FM
65×40 2½×1½	76.1×48.3 3.000×1.900	500 3.45	76 3.00	76 3.00	UL FM VdS LPCB
65×50 2½×2	76.1×60.3 3.000×2.375	500 3.45	69 2.72	76 3.00	UL FM VdS LPCB
80×32 3×1	88.9×33.7 3.500×1.315	500 3.45	108 4.25	108 4.25	UL FM VdS LPCB
80×32 3×1¼	88.9×42.4 3.500×1.660	500 3.45	85.5 3.37	85.5 3.37	UL FM
80×40 3×1½	88.9×48.3 3.500×1.900	500 3.45	85.5 3.37	85.5 3.37	UL FM VdS LPCB
80×50 3×2	88.9×60.3 3.500×2.375	500 3.45	85.5 3.37	85.5 3.37	UL FM VdS LPCB
80×65 3×2½	88.9×73.0 3.500×2.875	500 3.45	85.5 3.37	85.5 3.37	UL FM
80×65 3×2¾	88.9×76.1 3.500×3.000	500 3.45	85.5 3.37	85.5 3.37	UL FM VdS LPCB
100×50 4×2	108.0×60.3 4.250×2.375	500 3.45	101 3.98	101 3.98	UL FM
100×80 4×3	108.0×88.9 4.250×3.500	500 3.45	98 3.98	101 3.98	UL FM
100×25 4×1	114.3×33.7 4.500×1.315	500 3.45	101 3.98	101 3.98	UL FM VdS LPCB
100×40 4×1½	114.3×48.3 4.500×1.900	500 3.45	101 3.98	101 3.98	UL FM VdS LPCB
100×50 4×2	114.3×60.3 4.500×2.375	500 3.45	101 3.98	101 3.98	UL FM VdS LPCB
100×65 4×2½	114.3×73.0 4.500×2.875	500 3.45	101 3.98	101 3.98	UL FM
100×65 4×2¾	114.3×76.1 4.500×3.000	500 3.45	101 3.98	101 3.98	UL FM VdS LPCB
100×80 4×3	114.3×88.9 4.500×3.500	500 3.45	101 3.98	101 3.98	UL FM VdS LPCB
125×50 5×2	133.0×60.3 5.250×2.375	500 3.45	124 4.88	124 4.88	UL FM
125×65 5×2½	133.0×76.1 5.250×3.000	500 3.45	124 4.88	124 4.88	UL FM
125×100 5×4	133.0×108.0 5.250×4.250	500 3.45	124 4.88	124 4.88	UL FM
125×100 5×4	133.0×114.3 5.250×4.500	500 3.45	124 4.88	124 4.88	UL FM
125×40 5×1½	139.7×48.3 5.500×1.900	500 3.45	124 4.88	124 4.88	UL FM
125×50 5×2	139.7×60.3 5.500×2.375	500 3.45	124 4.88	124 4.88	UL FM
125×65 5×2¾	139.7×76.1 5.500×3.000	500 3.45	124 4.88	124 4.88	UL FM
125×80 5×3	139.7×88.9 5.500×3.500	500 3.45	124 4.88	124 4.88	UL FM
125×100 5×4	139.7×114.3 5.500×4.500	500 3.45	124 4.88	124 4.88	UL FM VdS LPCB
125×50 5×2	141.3×60.3 5.563×2.375	500 3.45	124 4.88	124 4.88	UL FM
125×80 5×3	141.3×88.9 5.563×3.500	500 3.45	124 4.88	124 4.88	UL FM
125×100 5×4	141.3×114.3 5.563×4.500	500 3.45	124 4.88	124 4.88	UL FM
150×60 6×2	159.0×60.3 6.250×2.375	500 3.45	140 5.50	140 5.50	UL FM
150×65 6×2½	159.0×76.1 6.250×3.000	500 3.45	140 5.50	140 5.50	UL FM
150×80 6×3	159.0×88.9 6.250×3.500	500 3.45	140 5.50	140 5.50	UL FM
150×100 6×4	159.0×108.0 6.250×4.250	500 3.45	140 5.50	140 5.50	UL FM
150×100 6×4	159.0×114.3 6.250×4.500	500 3.45	140 5.50	140 5.50	UL FM

130R

Reducing Tee

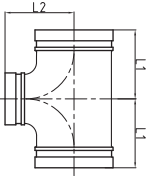

Nominal Size mm/in	Pipe O.D mm/in	Working Pressure PSI/MPa	Dimensions L 1 mm/in	Dimensions L 2 mm/in	Certificate
150 × 125 6 × 5	159.0 × 133.0 6.250 × 5.250	500 3.45	140 5.50	140 5.50	UL FM
150 × 50 6 × 2	165.1 × 60.3 6.500 × 2.375	300 2.07	140 5.50	140 5.50	UL FM
150 × 65 6 × 2½	165.1 × 76.1 6.500 × 3.000	300 2.07	140 5.50	140 5.50	UL FM
150 × 80 6 × 3	165.1 × 88.9 6.500 × 3.500	300 2.07	140 5.50	140 5.50	UL FM LPCB
150 × 100 6 × 4	165.1 × 114.3 6.500 × 4.500	300 2.07	140 5.50	140 5.50	UL FM LPCB
150 × 125 6 × 5	165.1 × 139.7 6.500 × 5.500	300 2.07	140 5.50	140 5.50	UL FM LPCB
165 × 133	165.1 × 133.0 6.500 × 5.250	300	140 5.50	140 5.50	UL
150 × 50 6 × 2	168.3 × 60.3 6.625 × 2.375	500 3.45	140 5.50	140 5.50	UL FM VdS LPCB
150 × 65 6 × 2½	168.3 × 73.0 6.625 × 2.875	500 3.45	140 5.50	140 5.50	UL FM
150 × 65 6 × 2½	168.3 × 76.1 6.625 × 3.000	500 3.45	140 5.50	140 5.50	UL FM VdS LPCB
150 × 80 6 × 3	168.3 × 88.9 6.625 × 3.500	500 3.45	140 5.50	140 5.50	UL FM VdS LPCB
150 × 100 6 × 4	168.3 × 114.3 6.625 × 4.500	500 3.45	140 5.50	140 5.50	UL FM VdS LPCB
150 × 125 6 × 5	168.3 × 139.7 6.625 × 5.500	300 2.07	140 5.50	140 5.50	UL FM VdS LPCB
150 × 125 6 × 5	168.3 × 141.3 6.625 × 5.563	300 2.07	140 5.50	140 5.50	UL FM
200 × 100 8 × 4	216.3 × 114.3 8.516 × 4.500	300 2.07	175 6.89	175 6.89	—
200 × 150 8 × 6	216.3 × 165.1 8.516 × 6.500	300 2.07	175 6.89	175 6.89	UL FM
200 × 50 8 × 2	219.1 × 60.3 8.625 × 2.375	500 3.45	175 6.89	175 6.89	UL FM VdS LPCB
200 × 65 8 × 2½	219.1 × 76.1 8.625 × 3.000	300 2.07	175 6.89	175 6.89	UL FM
200 × 80 8 × 3	219.1 × 88.9 8.625 × 3.500	500 3.45	175 6.89	175 6.89	UL FM VdS LPCB
200 × 100 8 × 4	219.1 × 108.0 8.625 × 4.250	500 3.45	175 6.89	175 6.89	UL FM
200 × 100 8 × 4	219.1 × 114.3 8.625 × 4.500	500 3.45	175 6.89	175 6.89	UL FM VdS LPCB
200 × 125 8 × 5	219.1 × 133.0 8.625 × 5.250	300 2.07	175 6.89	175 6.89	UL FM
200 × 125 8 × 5	219.1 × 139.7 8.625 × 5.500	300 2.07	175 6.89	175 6.89	UL FM
200 × 150 8 × 6	219.1 × 159.0 8.625 × 6.250	300 2.07	175 6.89	175 6.89	UL FM
200 × 150 8 × 6	219.1 × 165.1 8.625 × 6.500	300 2.07	175 6.89	175 6.89	UL FM
200 × 150 8 × 6	219.1 × 168.3 8.625 × 6.625	500 3.45	175 6.89	175 6.89	UL FM VdS LPCB
250 × 150 10 × 6	273.0 × 159.0 10.750 × 6.250	500 3.45	229 9.00	229 9.00	UL FM
250 × 150 10 × 6	273.0 × 165.1 10.750 × 6.500	300 2.07	229 9.00	229 9.00	UL FM
250 × 150 10 × 6	273.0 × 168.3 10.750 × 6.625	300 2.07	229 9.00	229 9.00	UL FM VdS
250 × 200 10 × 8	273.0 × 219.1 10.750 × 8.625	300 2.07	229 9.00	229 9.00	UL FM VdS
300 × 65 12 × 2½	323.9 × 73.0 12.750 × 2.875	300 2.07	254 10	254 10	—
300 × 80 12 × 3	323.9 × 88.9 12.750 × 3.500	300 2.07	254 10	254 10	—
300 × 150 12 × 6	323.9 × 165.1 12.750 × 6.500	300 2.07	254 10	254 10	UL FM
300 × 150 12 × 6	323.9 × 168.3 12.750 × 6.625	300 2.07	254 10	254 10	—
300 × 200 12 × 8	323.9 × 219.1 12.750 × 8.625	300 2.07	254 10	254 10	UL FM VdS
300 × 250 12 × 10	323.9 × 273.0 12.750 × 10.750	300 2.07	254 10	254 10	UL FM VdS
450 × 300 18 × 12	480.0 × 323.9 18.897 × 12.750	300 2.07	335 13.188	335 13.188	—
450 × 350 18 × 14	480.0 × 377.0 18.897 × 14.840	300 2.07	335 13.188	335 13.188	—

130R

Reducing Tee

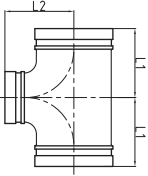

Nominal Size mm/in	Pipe O.D mm/in	Working Pressure PSU/MPa	Dimensions L 1 mm/in	Dimensions L 2 mm/in	Certificate
350 × 150 14 × 6	355.6 × 168.3 14.000 × 6.625	300 2.07	279 10.98	238 9.37	—
350 × 200 14 × 8	355.6 × 219.1 14.00 × 8.625	300 2.07	280 11.02	280 11.02	—
350 × 250 14 × 10	355.6 × 273.0 14.000 × 10.750	300 2.07	279 10.98	257 10.12	—
350 × 300 14 × 12	355.6 × 323.9 14.000 × 12.750	300 2.07	279 10.98	270 10.63	—
350 × 125 14 × 5	377.0 × 133.0 14.840 × 5.250	300 2.07	240 9.45	265 10.43	—
350 × 150 14 × 6	377.0 × 159.0 14.840 × 6.250	300 2.07	240 9.45	265 10.43	—
350 × 200 14 × 8	377.0 × 219.1 14.840 × 8.625	300 2.07	240 9.45	265 10.43	—
350 × 250 14 × 10	377.0 × 273.0 14.840 × 10.750	300 2.07	240 9.45	265 10.43	—
350 × 300 14 × 12	377.0 × 323.9 14.840 × 12.750	300 2.07	240 9.45	265 10.43	—
400 × 150 16 × 6	406.4 × 168.3 16.000 × 6.625	300 2.07	305 12.01	285 11.22	—
400 × 200 16 × 8	406.4 × 219.1 16.000 × 8.625	300 2.07	305 12.01	273 10.75	—
400 × 250 16 × 10	406.4 × 273.0 16.000 × 10.750	300 2.07	305 12.01	283 11.14	—
400 × 300 16 × 12	406.4 × 323.9 16.000 × 12.750	300 2.07	305 12.01	295 11.61	—
400 × 350 16 × 14	406.4 × 355.6 16.000 × 14.000	300 2.07	305 12.01	305 12.01	—
400 × 125 16 × 5	426.0 × 133.0 16.772 × 5.250	300 2.07	260 10.24	285 11.22	—
400 × 150 16 × 6	426.0 × 159.0 16.772 × 6.250	300 2.07	260 10.24	285 11.22	—
400 × 200 16 × 8	426.0 × 219.1 16.772 × 8.625	300 2.07	260 10.24	285 11.22	—
400 × 250 16 × 10	426.0 × 273.0 16.772 × 10.750	300 2.07	260 10.24	285 11.22	—
400 × 300 16 × 12	426.0 × 323.9 16.772 × 12.750	300 2.07	260 10.24	285 11.22	—
450 × 150 18 × 6	457.2 × 168.3 18.000 × 6.625	300 2.07	343 13.50	298 11.73	—
450 × 200 18 × 8	457.2 × 219.1 18.000 × 8.625	300 2.07	343 13.50	298 11.73	—
450 × 250 18 × 10	457.2 × 273.0 18.000 × 10.750	300 2.07	343 13.50	308 12.13	—
450 × 300 18 × 12	457.2 × 323.9 18.000 × 12.750	300 2.07	343 13.50	321 12.64	—
450 × 350 18 × 14	457.2 × 355.6 18.000 × 14.000	300 2.07	343 13.50	330 12.99	—
450 × 400 18 × 16	457.2 × 406.4 18.000 × 16.000	300 2.07	343 13.50	330 12.99	—
500 × 150 20 × 6	508.0 × 168.3 20.000 × 6.625	300 2.07	381 15.00	324 12.76	—
500 × 200 20 × 8	508.0 × 219.1 20.000 × 8.625	300 2.07	381 15.00	324 12.76	—
500 × 250 20 × 10	508.0 × 273.0 20.000 × 10.750	300 2.07	381 15.00	333 13.11	—
500 × 300 20 × 12	508.0 × 323.9 20.000 × 12.750	300 2.07	381 15.00	346 13.62	—
500 × 350 20 × 14	508.0 × 355.6 20.000 × 14.000	300 2.07	381 15.00	356 14.02	—
500 × 400 20 × 16	508.0 × 406.4 20.000 × 16.000	300 2.07	381 15.00	356 14.02	—
500 × 450 20 × 18	508.0 × 457.2 20.000 × 18.000	300 2.07	381 15.00	368 14.49	—
600 × 150 24 × 6	609.6 × 168.3 24.000 × 6.625	300 2.07	432 17.01	384 15.12	—
600 × 200 24 × 8	609.6 × 219.1 24.000 × 8.625	300 2.07	432 17.01	384 15.12	—
600 × 250 24 × 10	609.6 × 273.0 24.000 × 10.750	300 2.07	432 17.01	384 15.12	—
600 × 300 24 × 12	609.6 × 323.9 24.000 × 12.750	300 2.07	432 17.01	397 15.63	—
600 × 350 24 × 14	609.6 × 355.6 24.000 × 14.000	300 2.07	432 17.01	406 15.98	—
600 × 400 24 × 16	609.6 × 406.4 24.000 × 16.000	300 2.07	432 17.01	406 15.98	—
600 × 450 24 × 18	609.6 × 457.2 24.000 × 18.000	300 2.07	432 17.01	419 16.50	—
600 × 500 24 × 20	609.6 × 508.0 24.000 × 20.000	300 2.07	432 17.01	432 17.01	—

Segmental sizes are made of carbon steel pipe or fabricated from wrought carbon steel. Contact manufacturer for details.