



\* Reference photo

**Material:** ASTM A403 304L  
**Design:** ASME / ANSI B16.9  
**Ends:** Butt Welded  
**Schedule:** SCH 40S

### TENSILE REQUIREMENTS

MATERIAL	Yield Strength, min, ksi [MPa]	Tensile Strength, min, ksi [MPa]
304L	25 [170]	70 [485]

### DIMENSIONS

Nominal Pipe Size (NPS)	Outside Diameter at Bevel, mm (in.)	Center-to-End, B, mm (in.)	Nominal Wall Thickness, mm (in.)	Approx. Weight, kg
1/2	21.3 (0.84)	16 (0.62)	2.77 (0.109)	0.052
3/4	26.7 (1.05)	19 (0.75)	2.87 (0.113)	0.077
1	33.4 (1.32)	22 (0.88)	3.38 (0.133)	0.13
1 1/4	42.2 (1.66)	25 (1.00)	3.56 (0.14)	0.184
1 1/2	48.3 (1.90)	29 (1.12)	3.68 (0.145)	1.02
2	60.3 (2.38)	35 (1.38)	3.91 (0.154)	0.683
2 1/2	73.0 (2.88)	44 (1.75)	5.16 (0.203)	1.02
3	88.9 (3.50)	51 (2.00)	5.49 (0.216)	1.41
3 1/2	101.6 (4.00)	57 (2.25)	5.74 (0.226)	1.92
4	114.3 (4.50)	64 (2.50)	6.02 (0.237)	3.42
5	141.3 (5.56)	79 (3.12)	6.55 (0.258)	5.45
6	168.3 (6.62)	95 (3.75)	7.11 (0.28)	10.1
8	219.1 (8.62)	127 (5.00)	8.18 (0.322)	18
10	273.0 (10.75)	159 (6.25)	9.27 (0.365)	28.1
12	323.8 (12.75)	190 (7.50)	9.53 (0.375)	35.15
14	355.6 (14.00)	222 (8.75)	9.53 (0.375)	-
16	406.4 (16.00)	254 (10.00)	9.53 (0.375)	-
18	457.0 (18.00)	286 (11.25)	9.53 (0.375)	-
20	508.0 (20.00)	318 (12.50)	9.53 (0.375)	-
22	559.0 (22.00)	343 (13.50)	... (...)	-
24	610.0 (24.00)	381 (15.00)	9.53 (0.375)	-

### PERMITTED VARIATIONS IN WALL THICKNESS

NPS Designator	Tolerance, % from Nominal	
	Over	Under
1/8 to 2 1/2 incl., all t/D ratios	20.0	12.5
3 to 18 incl., t/D up to 5 % incl.	22.5	12.5
3 to 18 incl., t/D > 5%	15.0	12.5

where:

t = Nominal Wall Thickness

D = Ordered Outside Diameter

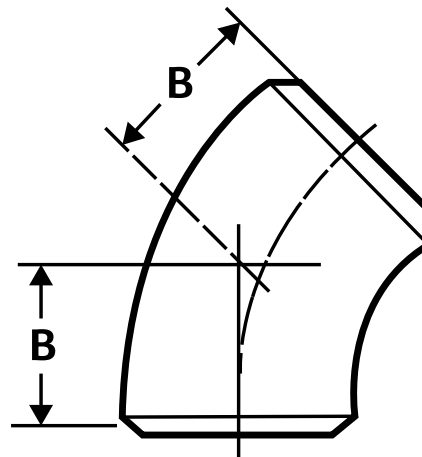

Speed Logística y Servicios S.A.C.  
 Importador y distribuidor autorizado de productos HGA  
 para Perú y para su exportación.

\* Conversion equivalents are approximate. Reference weights.

\* Photos and reference data. Reference weights. We accept no liability for incorrect uses or misinterpretations of this data.