



* Reference photo

Material: ASTM A403 304L
Design: ASME / ANSI B16.9
Ends: Butt Welded
Schedule: SCH 10S

TENSILE REQUIREMENTS

MATERIAL	Yield Strength, min, ksi [MPa]	Tensile Strength, min, ksi [MPa]
304L	25 [170]	70 [485]

DIMENSIONS

Nominal Pipe Size (NPS)	Outside Diameter at Bevel, mm (in.)	Center-to-End, B, mm (in.)	Nominal Wall Thickness, mm (in.)	Approx. Weight, kg
1/2	21.3 (0.84)	38 (1.50)	2.11 (0.083)	0.065
3/4	26.7 (1.05)	38 (1.50)	2.11 (0.083)	0.07
1	33.4 (1.32)	38 (1.50)	2.77 (0.109)	0.14
1 1/4	42.2 (1.66)	48 (1.88)	2.77 (0.109)	0.22
1 1/2	48.3 (1.90)	57 (2.25)	2.77 (0.109)	0.3
2	60.3 (2.38)	76 (3.00)	2.77 (0.109)	0.5
2 1/2	73.0 (2.88)	95 (3.75)	3.05 (0.12)	0.84
3	88.9 (3.50)	114 (4.50)	3.05 (0.12)	1.23
3 1/2	101.6 (4.00)	133 (5.25)	3.05 (0.12)	2.11
4	114.3 (4.50)	152 (6.00)	3.05 (0.12)	3.64
5	141.3 (5.56)	190 (7.50)	3.4 (0.134)	5.24
6	168.3 (6.62)	229 (9.00)	3.4 (0.134)	11
8	219.1 (8.62)	305 (12.00)	3.76 (0.148)	16
10	273.0 (10.75)	381 (15.00)	4.19 (0.165)	26
12	323.8 (12.75)	457 (18.00)	4.57 (0.18)	36.29
14	355.6 (14.00)	533 (21.00)	4.78 (0.188)	-
16	406.4 (16.00)	610 (24.00)	4.78 (0.188)	-
18	457.0 (18.00)	686 (27.00)	4.78 (0.188)	-
20	508.0 (20.00)	762 (30.00)	5.54 (0.218)	-
22	559.0 (22.00)	838 (33.00)	5.54 (0.218)	-
24	610.0 (24.00)	914 (36.00)	6.35 (0.25)	-

* Conversion equivalents are approximate. Reference weights.

PERMITTED VARIATIONS IN WALL THICKNESS

NPS Designator	Tolerance, % from Nominal	
	Over	Under
1/8 to 2 1/2 incl., all t/D ratios	20.0	12.5
3 to 18 incl., t/D up to 5 % incl.	22.5	12.5
3 to 18 incl., t/D > 5%	15.0	12.5

where:

t = Nominal Wall Thickness
D = Ordered Outside Diameter

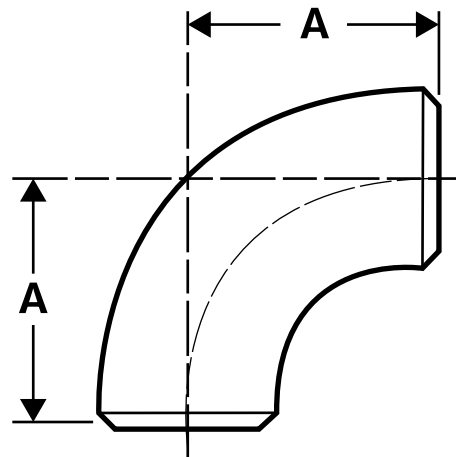

Speed Logística y Servicios S.A.C.
Importador y distribuidor autorizado de productos HGA
para Perú y para su exportación.

* Photos and reference data. Reference weights. We accept no liability for incorrect uses or misinterpretations of this data.