



\* Reference photo

**Material:** ASTM A403 304L  
**Design:** ASME / ANSI B16.9  
**Ends:** Butt Welded  
**Schedule:** SCH 40S

### TENSILE REQUIREMENTS

| MATERIAL | Yield Strength, min, ksi [MPa] | Tensile Strength, min, ksi [MPa] |
|----------|--------------------------------|----------------------------------|
| 304L     | 25 [170]                       | 70 [485]                         |

### DIMENSIONS

| Nominal Pipe Size (NPS) | Outside Diameter at Bevel, mm (in.) | Center-to-End, B, mm (in.) | Nominal Wall Thickness, mm (in.) | Approx. Weight, kg |
|-------------------------|-------------------------------------|----------------------------|----------------------------------|--------------------|
| 1/2                     | 21.3 (0.84)                         | 38 (1.50)                  | 2.77 (0.109)                     | 0.082              |
| 3/4                     | 26.7 (1.05)                         | 38 (1.50)                  | 2.87 (0.113)                     | 0.09               |
| 1                       | 33.4 (1.32)                         | 38 (1.50)                  | 3.38 (0.133)                     | 0.16               |
| 1 1/4                   | 42.2 (1.66)                         | 48 (1.88)                  | 3.56 (0.14)                      | 0.27               |
| 1 1/2                   | 48.3 (1.90)                         | 57 (2.25)                  | 3.68 (0.145)                     | 0.5                |
| 2                       | 60.3 (2.38)                         | 76 (3.00)                  | 3.91 (0.154)                     | 0.69               |
| 2 1/2                   | 73.0 (2.88)                         | 95 (3.75)                  | 5.16 (0.203)                     | 1.36               |
| 3                       | 88.9 (3.50)                         | 114 (4.50)                 | 5.49 (0.216)                     | 2.13               |
| 3 1/2                   | 101.6 (4.00)                        | 133 (5.25)                 | 5.74 (0.226)                     | 4.05               |
| 4                       | 114.3 (4.50)                        | 152 (6.00)                 | 6.02 (0.237)                     | 6.87               |
| 5                       | 141.3 (5.56)                        | 190 (7.50)                 | 6.55 (0.258)                     | 10.68              |
| 6                       | 168.3 (6.62)                        | 229 (9.00)                 | 7.11 (0.28)                      | 21                 |
| 8                       | 219.1 (8.62)                        | 305 (12.00)                | 8.18 (0.322)                     | 32                 |
| 10                      | 273.0 (10.75)                       | 381 (15.00)                | 9.27 (0.365)                     | 52                 |
| 12                      | 323.8 (12.75)                       | 457 (18.00)                | 9.53 (0.375)                     | 70.31              |
| 14                      | 355.6 (14.00)                       | 533 (21.00)                | 9.53 (0.375)                     | -                  |
| 16                      | 406.4 (16.00)                       | 610 (24.00)                | 9.53 (0.375)                     | -                  |
| 18                      | 457.0 (18.00)                       | 686 (27.00)                | 9.53 (0.375)                     | -                  |
| 20                      | 508.0 (20.00)                       | 762 (30.00)                | 9.53 (0.375)                     | -                  |
| 22                      | 559.0 (22.00)                       | 838 (33.00)                | ... (...)                        | -                  |
| 24                      | 610.0 (24.00)                       | 914 (36.00)                | 9.53 (0.375)                     | -                  |

\* Conversion equivalents are approximate. Reference weights.

### PERMITTED VARIATIONS IN WALL THICKNESS

| NPS Designator                     | Tolerance, % from Nominal |       |
|------------------------------------|---------------------------|-------|
|                                    | Over                      | Under |
| 1/8 to 2 1/2 incl., all t/D ratios | 20.0                      | 12.5  |
| 3 to 18 incl., t/D up to 5 % incl. | 22.5                      | 12.5  |
| 3 to 18 incl., t/D > 5%            | 15.0                      | 12.5  |

where:

t = Nominal Wall Thickness

D = Ordered Outside Diameter

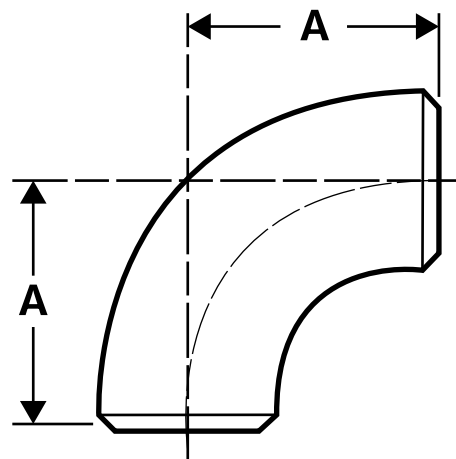

Speed Logística y Servicios S.A.C.  
 Importador y distribuidor autorizado de productos HGA  
 para Perú y para su exportación.

\* Photos and reference data. Reference weights. We accept no liability for incorrect uses or misinterpretations of this data.