



\* Reference photo

**Material:** ASTM A403 316L  
**Design:** ASME / ANSI B16.9  
**Ends:** Butt Welded  
**Schedule:** SCH 40S

### TENSILE REQUIREMENTS

MATERIAL	Yield Strength, min, ksi [MPa]	Tensile Strength, min, ksi [MPa]
316L	25 [170]	70 [485]

### DIMENSIONS

Nominal Pipe Size (NPS)	Outside Diameter at Bevel, mm (in.)	Center-to-End, B, mm (in.)	Nominal Wall Thickness, mm (in.)	Approx. Weight, kg
1/2	21.3 (0.84)	38 (1.50)	2.77 (0.109)	0.082
3/4	26.7 (1.05)	38 (1.50)	2.87 (0.113)	0.09
1	33.4 (1.32)	38 (1.50)	3.38 (0.133)	0.16
1 1/4	42.2 (1.66)	48 (1.88)	3.56 (0.14)	0.27
1 1/2	48.3 (1.90)	57 (2.25)	3.68 (0.145)	0.5
2	60.3 (2.38)	76 (3.00)	3.91 (0.154)	0.69
2 1/2	73.0 (2.88)	95 (3.75)	5.16 (0.203)	1.36
3	88.9 (3.50)	114 (4.50)	5.49 (0.216)	2.13
3 1/2	101.6 (4.00)	133 (5.25)	5.74 (0.226)	4.05
4	114.3 (4.50)	152 (6.00)	6.02 (0.237)	6.87
5	141.3 (5.56)	190 (7.50)	6.55 (0.258)	10.68
6	168.3 (6.62)	229 (9.00)	7.11 (0.28)	21
8	219.1 (8.62)	305 (12.00)	8.18 (0.322)	32
10	273.0 (10.75)	381 (15.00)	9.27 (0.365)	52
12	323.8 (12.75)	457 (18.00)	9.53 (0.375)	70.31
14	355.6 (14.00)	533 (21.00)	9.53 (0.375)	-
16	406.4 (16.00)	610 (24.00)	9.53 (0.375)	-
18	457.0 (18.00)	686 (27.00)	9.53 (0.375)	-
20	508.0 (20.00)	762 (30.00)	9.53 (0.375)	-
22	559.0 (22.00)	838 (33.00)	... (...)	-
24	610.0 (24.00)	914 (36.00)	9.53 (0.375)	-

\* Conversion equivalents are approximate. Reference weights.

### PERMITTED VARIATIONS IN WALL THICKNESS

NPS Designator	Tolerance, % from Nominal	
	Over	Under
1/8 to 2 1/2 incl., all t/D ratios	20.0	12.5
3 to 18 incl., t/D up to 5 % incl.	22.5	12.5
3 to 18 incl., t/D > 5%	15.0	12.5

where:

t = Nominal Wall Thickness

D = Ordered Outside Diameter

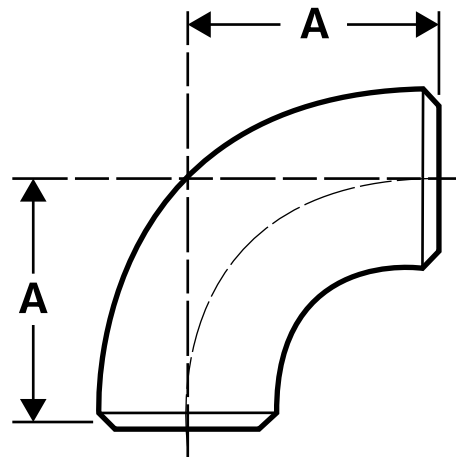

Speed Logística y Servicios S.A.C.  
 Importador y distribuidor autorizado de productos HGA  
 para Perú y para su exportación.

\* Photos and reference data. Reference weights. We accept no liability for incorrect uses or misinterpretations of this data.