



* Reference photo

Material: ASTM A403 316L
Design: ASME / ANSI B16.9
Ends: Butt Welded
Schedule: SCH 40S

TENSILE REQUIREMENTS

MATERIAL	Yield Strength, min, ksi [MPa]	Tensile Strength, min, ksi [MPa]
316L	25 [170]	70 [485]

DIMENSIONS

Nominal Pipe Size (NPS)	Outside Diameter at Bevel, mm (in.)	Center-to-End, mm (in.)		Nominal Wall Thickness, mm (in.)	Approx. Weight, kg
		Run, C	Outlet, M		
1/2	21.3 (0.84)	25 (1.00)	25 (1.00)	2.77(0.109)	0.17
3/4	26.7 (1.05)	29 (1.12)	29 (1.12)	2.87(0.113)	0.21
1	33.4 (1.32)	38 (1.50)	38 (1.50)	3.38(0.133)	0.35
1 1/4	42.2 (1.66)	48 (1.88)	48 (1.88)	3.56(0.14)	0.6
1 1/2	48.3 (1.90)	57 (2.25)	57 (2.25)	3.68(0.145)	0.92
2	60.3 (2.38)	64 (2.50)	64 (2.50)	3.91(0.154)	1.6
2 1/2	73.0 (2.88)	76 (3.00)	76 (3.00)	5.16(0.203)	3.19
3	88.9 (3.50)	86 (3.38)	86 (3.38)	5.49(0.216)	3.3
3 1/2	101.6 (4.00)	95 (3.75)	95 (3.75)	5.74(0.226)	-
4	114.3 (4.50)	105(4.12)	105(4.12)	6.02(0.237)	5.46
5	141.3 (5.56)	124(4.88)	124(4.88)	6.55(0.258)	9.63
6	168.3 (6.62)	143(5.62)	143(5.62)	7.11(0.28)	11.42
8	219.1 (8.62)	178(7.00)	178(7.00)	8.18(0.322)	21
10	273.0 (10.75)	216(8.50)	216(8.50)	9.27(0.365)	26.6
12	323.8 (12.75)	254(10.00)	254(10.00)	9.53(0.375)	39
14	355.6 (14.00)	279(11.00)	279(11.00)	9.53(0.375)	-
16	406.4 (16.00)	305(12.00)	305(12.00)	9.53(0.375)	-

PERMITTED VARIATIONS IN WALL THICKNESS

NPS Designator	Tolerance, % from Nominal	
	Over	Under
1/8 to 2 1/2 incl., all t/D ratios	20.0	12.5
3 to 18 incl., t/D up to 5 % incl.	22.5	12.5
3 to 18 incl., t/D > 5%	15.0	12.5

where:

t = Nominal Wall Thickness
D = Ordered Outside Diameter

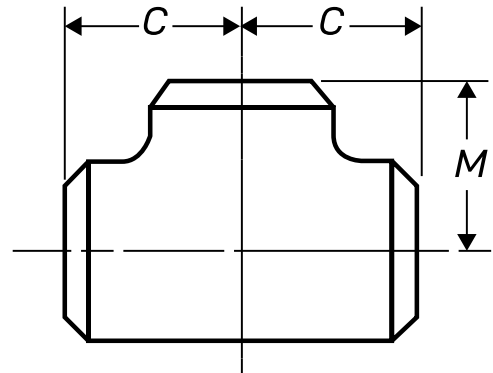

Speed Logística y Servicios S.A.C.
Importador y distribuidor autorizado de productos HGA
para Perú y para su exportación.

* Conversion equivalents are approximate. Reference weights.

* Photos and reference data. Reference weights. We accept no liability for incorrect uses or misinterpretations of this data.