



(Technical communication n° A-018)

**a**

A89 Swivel

Product

Available with pin or rocker lugs

a
2 1/2"

[Product](#)
[Thread](#)
[Dimensions](#)
[HOME](#)

Thread

A89X011	2 1/2" NST PL CR
A89X070	2 1/2" NWFD RL CR
A89X072	2 1/2" NSST RL CR
A89X111	2 1/2" NST PL CRL
A89X112	2 1/2" NST RL CRL
A89X162	2 1/2" CSA RL CRL
A89X164	2 1/2" BCT RL CRL
A89X166	2 1/2" QST RL CRL
A89X168	2 1/2" WCT RL CRL
A89X170	2 1/2" NWFD RL CRL
A89X172	2 1/2" NSST RL CRL
A89X174	2 1/2" NPSH RL CRL
A89Y011	2 1/2" NST PL GL
A89Y013	2 1/2" NYFD PL GL
A89Y017	2 1/2" NCFD PL GL
A89Y019	3" NST PL GL
A89Y021	3" NYFD PL GL
A89Y062	2 1/2" CSA RL GL
A89Y066	2 1/2" QST RL GL
A89Y067	2 1/2" WCT PL GL
A89Y068	2 1/2" WCT RL GL
A89Y070	2 1/2" NWFLDRL GL
A89Y072	2 1/2" NSST RL GL
A89Y074	2 1/2" NPSH RL GL
A89Y111	2 1/2" NST PL LUC
A89Y112	2 1/2" NST RL LUC
A89Y117	2 1/2" NCFD PL LUC
A89Y119	3" NST PL LUC
A89Y121	3" NYFD PL LUC
A89Y162	2 1/2" CSA RL LUC
A89Y164	2 1/2" BCT RL LUC

---- Abbreviation List ----

[Product](#)
[Thread](#)
[Dimensions](#)
[HOME](#)

A89Y166	2 1/2" QST RL LUC
A89Y168	2 1/2" WCT RL LUC
A89Y170	2 1/2" NWFLDRL LUC
A89Y172	2 1/2" NSST RL LUC
A89Y174	2 1/2" NPSH RL LUC

Dimensions

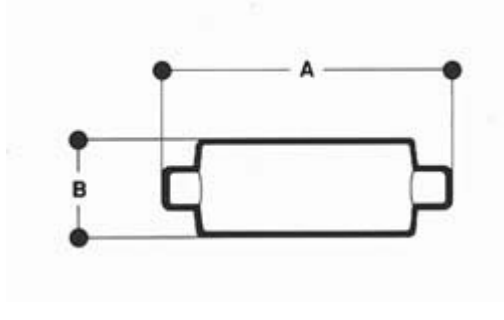

	2 1/2"
A	4 9/64"
B	1 29/64"

[Product](#)
[Thread](#)
[Dimensions](#)

HOME