

D151

Bronze Gate Valve



Sizes 1/2"-2" only

PN20

D151

GENERAL VALVES

Features & Benefits

- Crane gate valves offer the ultimate in dependable service wherever minimum pressure drop is important
- The D151 carries the British Standards Institution kitemark - your assurance of exacting quality standards
- WRAS approved for use on wholesome (potable) water in sizes 1/2" – 2" only
- WRAS approval temperature 85°C max

Materials

PART	MATERIAL	SIZES
Body	Bronze BS EN 1982 CC491K	All
Bonnet	Bronze BS EN 1982 CC491K	All
Stem	DZR Brass BS EN 12164 CW602N	1/4 - 3
Stem	Manganese Bronze	4
Disc	Bronze BS EN 1982 CC491K	All
Stem Retainer	DZR Brass BS EN 12164 CW602N	1/2 - 2
Stuffing Box	DZR Brass BS EN 12164 CW602N	1/4, 3/8, 2 1/2 & 3
Stuffing Box	Bronze BS EN 1982 CC491K	4
Packing	Asbestos Free	All
Packing Gland	Brass BS EN 12164 CW614N	1/4, 3/8, 1 - 3
Packing Gland Nut	Brass BS EN 12164 CW614N	1/2 & 3/4
Packing Gland	Bronze BS EN 1982 CC491K	4
Packing Nut	Brass BS EN 12164 CW614N	1/4 - 3
Packing Nut	Bronze BS EN 1982 CC491K	4
Handwheel	Aluminium	1/4 - 3
Handwheel	Malleable Iron BS EN 1562 GJMB-300-6	4
ID Plate	Aluminium	All
Handwheel Nut	Brass BS EN 12164 CW614N	All
Gasket	Asbestos Free	3 - 4



Dimensional Drawing

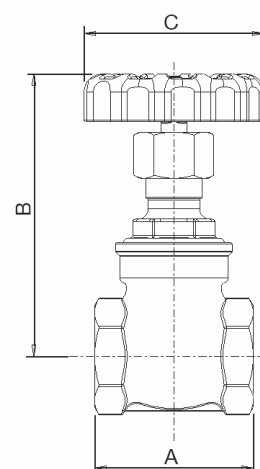

Dimensions & Weights

SIZE (inch)	WEIGHT (kg)	A (mm)	B (mm)	C (mm)
1/4	0.27	46	75	45
3/8	0.26	46	75	45
1/2	0.269	50	78	52.5
3/4	0.384	54	84	52.5
1	0.593	62	105	65
1 1/4	0.844	71	111	70
1 1/2	1.266	77.5	130	78
2	1.881	87.5	153	92
2 1/2	4.37	96	219	121
3	6.4	105	259	121
4	19.7	162	366	203

Pressure/Temperature Ratings

TEMPERATURE (°C)	-10 to 100	180
PRESSURE (BAR)	20	8

Intermediate pressure ratings shall be determined by interpolation.

PRESSURE RATING: PN20

TEMPERATURE OPERATING RANGE: -10 to 180°C

UK END CONNECTION: Taper threaded to BS EN 10226-2 (ISO 7-1) formerly BS 21

US END CONNECTION: ANSI B1.20.1

OPERATOR: Handwheel.

Gate valves are best for services that require infrequent valve operation, and where the disc is kept either fully opened or fully closed. They are not practical for throttling.

SPECIFICATION: Solid wedge disc, non-rising stem, screwed in bonnet. Valves are manufactured in accordance with BS EN 12288: 2010 PN20. Series B and are BSI Kitemark approved.

This valve is not suitable for use on Group 1 gases or unstable fluids, as defined by the Pressure Equipment Directive 97/23/EC.*

* See page 230 for more information

Valid as of 210515

Every effort has been made to ensure that the information contained in this publication is accurate at the time of publishing. Crane Ltd assumes no responsibility or liability for typographical errors or omissions or for any misinterpretation of the information within the publication and reserves the right to change without notice.