



* Reference photo

Body: Cast Iron ASTM A126
 Threaded NPT ANSI/ASME B1.20.1
 Strainer: Stainless Steel 304 (Opt. 316)
 Mesh: 40
 Working Pressure: 250 PSI SWP
 Hidrostatic Test API 598

MATERIALS

	PART NAME	MATERIAL
1	BODY COVER	ASTM A216 WCB
2	SCREEN	ASTM A167 304
3	BLOWOFF PLUG	ASTM A197

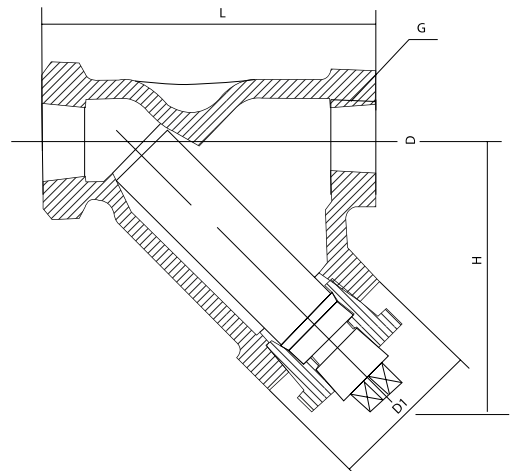

Speed Logística y Servicios S.A.C.
 Importador y distribuidor autorizado de
 válvulas REX para Perú y para su exportación.

DIMENSIONS (mm)

SIZE	L	D	D1	H	WEIGHT (Kg)
1/4"	73	32	36	65	0.5
1/2"	87	36	42	95	0.8
3/4"	111	45	51	124	1.3
1"	124	57	70	130	2.1
1 1/4"	137	70	78	150	3.5
1 1/2"	162	78	90	170	5
2"	191	86	102	200	7
3"	254	127	156	220	14

PRESSURE TEMPERATURE RATINGS

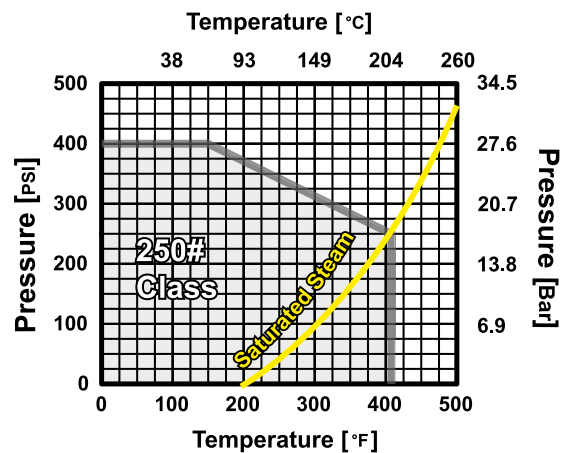

* Note : Dimensions, design and materials are subject to change without notice. Approximate weights.

MAC EDITIONS - MMXXIII

