

* Reference photo

Body and Cover Cast Steel A216 WCB
 Class 150
 Steel Valves: ASME B16.34
 Flange dimensions: ANSI B16.5 RF
 Face to Face dimensions: ANSI B16.10
 Screen: Stainless Steel 304 (Opt. 316)
 Mesh 40
 Hydrostatic Testing API 598

MATERIALS

	PART NAME	MATERIAL
1	BODY	A216 Gr. WCB
2	COVER	A216 Gr. WCB
3	SCREEN	304
4	GASKET	SS SPIRAL WOUND
5	STUDS	ALLOY STEEL
6	NUTS	ALLOY STEEL
7	BLOW-OFF PLUG NPT	CARBON STEEL

DIMENSIONS (mm)

SIZE	A	B	C	D	FACTOR CV	WEIGHT (Kg)
2"	200	134	178	15	70	9.5
2 1/2"	248	166	248	25	110	14.5
3"	256	178	254	25	160	15.9
4"	308	210	305	40	260	24.9
5"	397	286	508	50	400	40.8
6"	470	343	508	50	570	63.5
8"	543	394	578	50	950	99.7
10"	661	470	712	50	1600	161.5
12"	759	566	762	50	2200	292.1

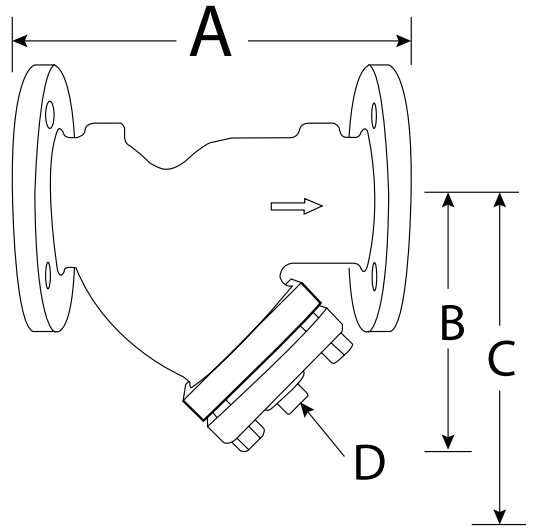

Speed Logística y Servicios S.A.C.
 Importador y distribuidor autorizado de
 válvulas REX para Perú y para su exportación.

PRESSURE TEMPERATURE RATINGS (PSI)

Temperature °F/°C	Class 150
(-) 20 °F / (-) 29 °C to (+) 100 °F / (+) 38 °C	285
200 °F / 93 °C	260
300 °F / 149 °C	230
400 °F / 204 °C	200
500 °F / 260 °C	170
600 °F / 316 °C	140
650 °F / 343 °C	125
700 °F / 371 °C	110
750 °F / 399 °C	95
800 °F / 427 °C	80
850 °F / 454 °C	65
900 °F / 482 °C	50

* Note : Dimensions, design and materials are subject to change without notice. Approximate weights.