



\* Reference photo

Body and Bonnet Cast Steel ASTM A216 WCB. High performance.  
 Bolted Bonnet. Rising Stem OS&Y.  
 Design, Manufacture, Test in accordance with API 623 TRIM N° 8  
 Norm Steel Valves: ANSI/ASME B16.34  
 Flange dimensions: ANSI B16.5 RF  
 Face to Face dimensions: ASME B16.10  
 Hydrostatic Testing API 598  
 \* Certification pending to norm API 623 from American Petroleum Institute

### MATERIALS

	PART NAME	MATERIAL
1	BODY, BONNET	ASTM A216 WCB
2	SEAT RING	ASTM A216 WCB + 13% CR
3	DISC	ASTM A216 + 13% CR
4	STEM	SS 410
5	STUD	ASTM A193 B7
6	NUT	ASTM A194 2H
7	GASKET	CORRUGATED SOFT STEEL
8	PACKING	GRAPHITE
9	STEM NUT	ASTM A439 D-2

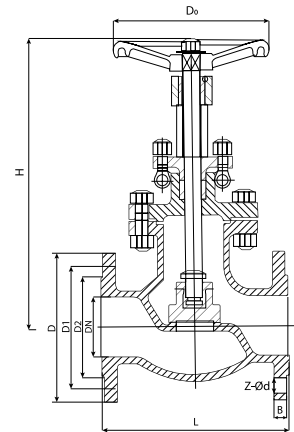

**Speed Logística y Servicios S.A.C.**  
 Importador y distribuidor autorizado de válvulas HG V para Perú y para su exportación.

### DIMENSIONS (mm)

SIZE	L	D	D1	D2	b	Z-Ød	D0	H	WEIGHT (Kg)
2"	203	152	120.5	92	16	4-19	200	362	16.50
2 1/2"	216	178	139.5	105	18	4-19	200	385	23
3"	241	190	152.5	127	19	4-19	250	410	31.50
4"	292	229	190.5	157	24	8-19	250	440	46.50
5"	356	252	216	179	22	8-22	315	420	64.50
6"	406	279	241.5	216	26	8-22	350	512	84.50
8"	495	343	298.5	270	29	8-22	450	598	141
10"	622	406	362	324	31	12-25	600	745	325
12"	699	483	432	381	32	12-25	700	819	430

### PRESSURE TEMPERATURE RATINGS (PSI)

Temperature °F/°C	Class 150
(-) 20 °F / (-) 29 °C to (+) 100 °F / (+) 38 °C	285
200 °F / 93 °C	260
300 °F / 149 °C	230
400 °F / 204 °C	200
500 °F / 260 °C	170
600 °F / 316 °C	140
650 °F / 343 °C	125
700 °F / 371 °C	110
750 °F / 399 °C	95
800 °F / 427 °C	80
850 °F / 454 °C	65
900 °F / 482 °C	50

\* Note : Dimensions, design and materials are subject to change without notice. Approximate weights.

