



Globe Cast Steel A216 WCB Class 150

Body and Bonnet Cast Steel A216 WCB
 Bolted Bonnet
 Rising Stem OS&Y
 Norm Steel Valves: ANSI/ASME B16.34
 Flange dimensions: ANSI/ASME B16.5 RF
 Face to Face dimensions: ANSI/ASME B16.10
 Hydrostatic Testing API 598
 Diameters: 2" to 12"

PRESSURE TEMPERATURE RATINGS

Temperature °F/°C	Pressure worked lbs/inch ² (PSI)
	Class 150
(-) 20 °F / (-) 29 °C a (+) 100 °F / (+) 38 °C	285
200 °F / 93 °C	260
300 °F / 149 °C	230
400 °F / 204 °C	200
500 °F / 260 °C	170
600 °F / 316 °C	140
650 °F / 343 °C	125
700 °F / 371 °C	110
750 °F / 399 °C	95
800 °F / 427 °C	80
850 °F / 454 °C	65
900 °F / 482 °C	50
950 °F / 510 °C	35
1000 °F / 538 °C	20



* Reference photo

* Note : Dimensions, design and materials are subject to change without notice.



Globe Cast Steel A216 WCB Class 150

MATERIALS

	PART NAME	MATERIAL
1	BODY, BONNET	ASTM A216 WCB
2	SEAT RING	ASTM A216 WCB + 13% CR
3	DISK	ASTM A216 + 13% CR
4	STEM	SS 410
5	STUD	ASTM A193 B7
6	NUT	ASTM A194 2H
7	GASKET	CORRUGATED SOFT STEEL
8	PACKING	GRAPHITE
9	STEM NUT	ASTM A439 D-2 OR ASTM B62

TEST API 598

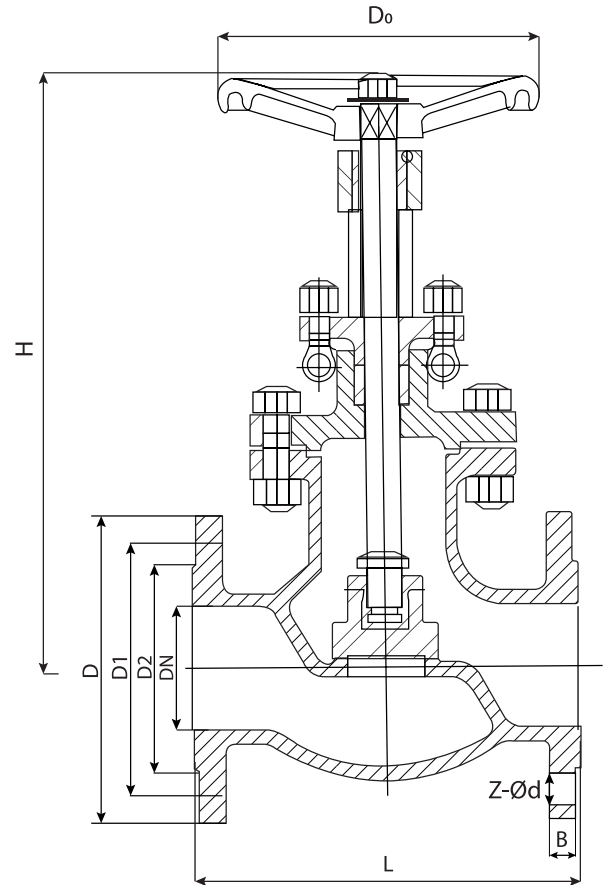

DIMENSIONS (mm)

SIZE	L	D	D ₁	D ₂	B	Z-Ød	D ₀	H	WEIGHT (KG)
2"	203	152	120.5	92	16	4-19	200	362	20
2 1/2"	216	178	139.5	105	18	4-19	200	385	30
3"	241	190	152.5	127	19	4-19	250	410	40
4"	292	229	190.5	157	24	8-19	250	440	58
6"	406	279	241.5	216	26	8-22	350	512	100
8"	495	343	298.5	270	29	8-22	450	598	159
10"	622	406	362	324	31	12-25	600	745	287
12"	699	483	432	381	32	12-25	700	819	430

* Note : Dimensions, design and materials are subject to change without notice.